

1 West Concourse

| DATE | SUBMITTAL |
|------------|----------------------------|
| 10/30/2014 | 100% Fabrication Submittal |

| REVISIONS | |
|------------|------------------------------|
| 09/30/2014 | 1. 65% Fabrication Submittal |
| xx/xx/xxxx | 2. xx |
| xx/xx/xxxx | 3. xx |
| xx/xx/xxxx | 4. xx |
| xx/xx/xxxx | 5. xx |
| xx/xx/xxxx | 6. xx |
| xx/xx/xxxx | 7. xx |

| | | | |
|---------------|-------------------------------|----------|------------|
| PROJECT | 1 West Landmark and Concourse | | |
| DRAWING TITLE | Cover Page | | |
| | DESIGNED BY | DRAWN BY | CHECKED BY |
| | F. A. | F. A. | |

TEAM MEMBERS

Curators: David Allison, Joan Boudreau, Art Mollala, Susan Tolbert, Drew Robarge
 Educator: Howard Morrison
 Designer: Farah Ahmed
 Project Managers: Andrew Heymann, Lauren Telchin-Katz
 Collections Manager: Katharine Klein

PAGES

| | | | |
|---------|--------------------------------|--------|---------------------------|
| 1W- 1 | Overall plan | | |
| 1W- 2 | Materials and Notes | | |
| 1W- 3 | Security notes | | |
| 1W- B1 | Workshop perspective | | |
| 1W- B2 | Plan | | |
| 1W- B3 | Platform & Wall details | | |
| 1W- B4 | Framing details | | |
| 1W- B5 | Back wall details | | |
| 1W- B6 | Power/ Lighting source details | | |
| 1W- B7 | Lighting details | | |
| 1W- B8 | TV & Console Case details | | |
| 1W- B9 | TV & Console Case details | | |
| 1W- B10 | Desk details | | |
| 1W- B11 | Brick wall perspective | | |
| 1W- B12 | Brick wall details | | |
| 1W- 4 | Steel structure | | |
| 1W- 5 | Spektaklar showcase | | |
| 1W- 6 | Spektaklar showcase | | |
| | | 1W-LC1 | Case perspective |
| | | 1W-LC2 | Case Artifacts |
| | | 1W-LC3 | Case plan & elevations |
| | | 1W-LC4 | Case details |
| | | 1W-LC5 | Case details |
| | | 1W-SC1 | Case perspective |
| | | 1W-SC2 | Case Artifacts |
| | | 1W-SC3 | Case plan& elevation |
| | | 1W-SC4 | Case details |
| | | 1W-SC5 | Interactive panel details |



1W Concourse 100% v2015 .wvx

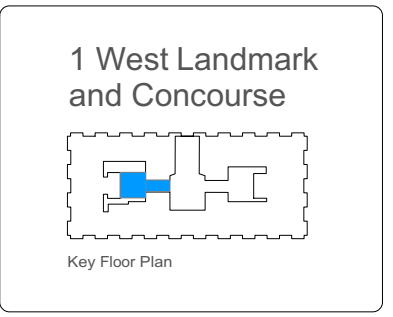

1 West Concourse
Notable Icon Case

| DATE | SUBMITTAL |
|------------|----------------------------|
| 10/30/2014 | 100% Fabrication Submittal |

| REVISIONS | |
|------------|------------------------------|
| 09/30/2014 | 1. 65% Fabrication Submittal |
| xx/xx/xxxx | 2. xx |
| xx/xx/xxxx | 3. xx |
| xx/xx/xxxx | 4. xx |
| xx/xx/xxxx | 5. xx |
| xx/xx/xxxx | 6. xx |
| xx/xx/xxxx | 7. xx |

| | | | |
|---------------|-------------------------------|----------|------------|
| PROJECT | 1 West Landmark and Concourse | | |
| DRAWING TITLE | Case Perspective | | |
| | DESIGNED BY | DRAWN BY | CHECKED BY |
| | F. A. | F. A. | |



Smithsonian
National Museum of American History
Kenneth E. Behring Center

1 West Landmark
and Concourse

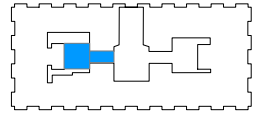

Key Floor Plan

1 West Concourse
Notable Icon Case

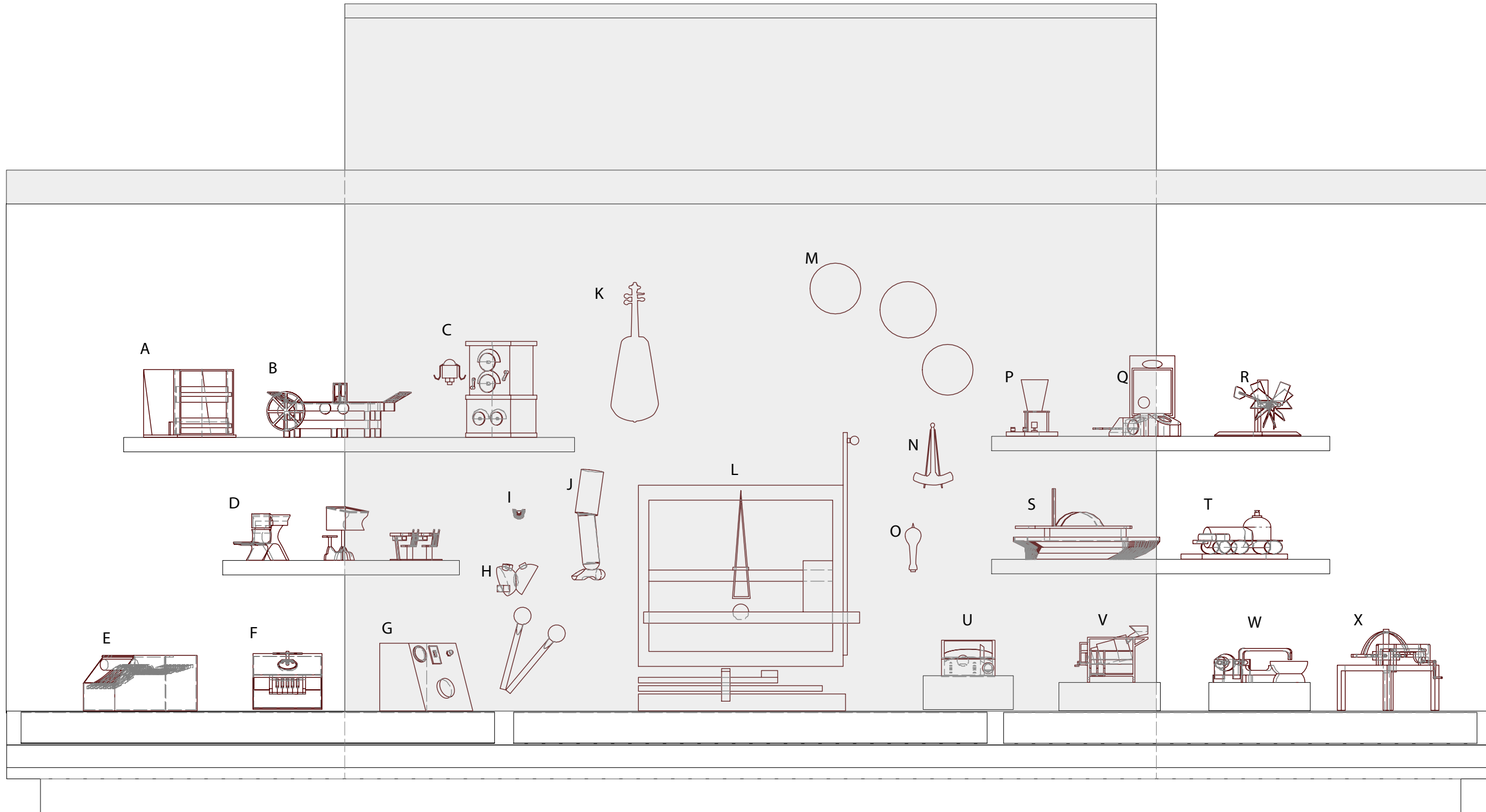

Artifacts:

- A Muybridge Model Camera
- B Isaac Adam's Printing Press
- C Audio Radio Tube & Armstrong Radio
- D School Desks
- E Adding Machine, Macaroni Box
- F Typewriter

- G Defibrillator
- H Artificial Heart
- I Denture
- J Artificial Leg
- K Hollow Back Violin
- L Morse Telegraph

- M White House China Hayes
- N Thermometer
- O Edison Incandescent Lamp
- P Bell's Liquid Transmitter
- Q Carterfone & Patent
- R Windmill

- S Sickels Steam Steering Gear
- T Flexible Beam Locomotive
- U Bagatelle
- V Vegetable Axssorter
- W Sewing Machine
- X Pin Machine

| DATE | SUBMITTAL |
|------------|----------------------------|
| 10/30/2014 | 100% Fabrication Submittal |

| REVISIONS | |
|------------|------------------------------|
| 09/30/2014 | 1. 65% Fabrication Submittal |
| xx/xx/xxxx | 2. xx |
| xx/xx/xxxx | 3. xx |
| xx/xx/xxxx | 4. xx |
| xx/xx/xxxx | 5. xx |
| xx/xx/xxxx | 6. xx |
| xx/xx/xxxx | 7. xx |

| | | | |
|---------------|-------------------------------|----------|------------|
| PROJECT | 1 West Landmark and Concourse | | |
| DRAWING TITLE | Case Artifacts | | |
| | DESIGNED BY | DRAWN BY | CHECKED BY |
| | F. A. | F. A. | |

1 West Landmark and Concourse

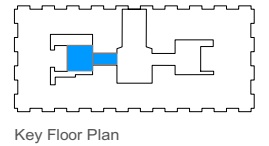

1 West Concourse Notable Icon Case

| DATE | SUBMITTAL |
|------------|----------------------------|
| 10/30/2014 | 100% Fabrication Submittal |

| REVISIONS | |
|------------|------------------------------|
| 09/30/2014 | 1. 65% Fabrication Submittal |
| xx/xx/xxxx | 2. xx |
| xx/xx/xxxx | 3. xx |
| xx/xx/xxxx | 4. xx |
| xx/xx/xxxx | 5. xx |
| xx/xx/xxxx | 6. xx |
| xx/xx/xxxx | 7. xx |

| | | | |
|---------------|-------------------------------|----------|------------|
| PROJECT | 1 West Landmark and Concourse | | |
| DRAWING TITLE | Case Plan & Elevation | | |
| | DESIGNED BY | DRAWN BY | CHECKED BY |
| | F. A. | F. A. | |

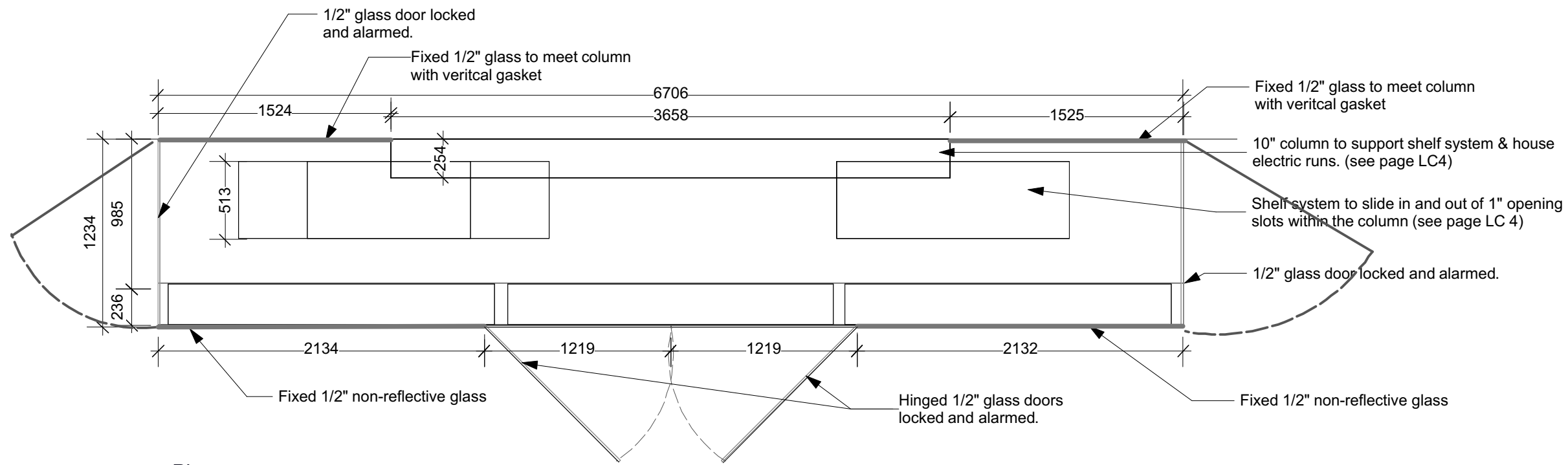

Plan

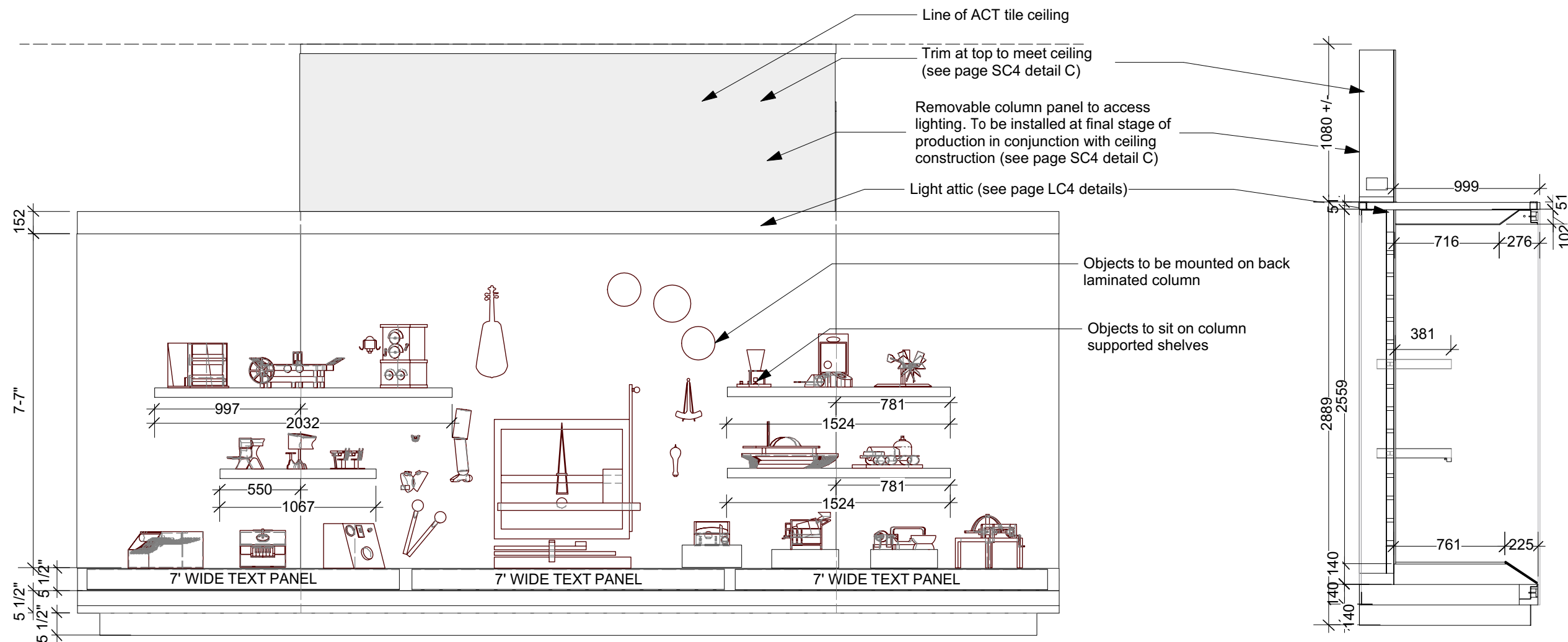

Front Elevation

Side Elevation



Smithsonian
National Museum of American History
Kenneth E. Behring Center

1 West Landmark
and Concourse

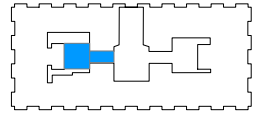

Key Floor Plan

1 West Concourse

Trademark Case
Hall of Fame Case
Interactive Panel



| DATE | SUBMITTAL |
|------------|----------------------------|
| 10/30/2014 | 100% Fabrication Submittal |

| REVISIONS | |
|------------|------------------------------|
| 09/30/2014 | 1. 65% Fabrication Submittal |
| xx/xx/xxxx | 2. xx |
| xx/xx/xxxx | 3. xx |
| xx/xx/xxxx | 4. xx |
| xx/xx/xxxx | 5. xx |
| xx/xx/xxxx | 6. xx |
| xx/xx/xxxx | 7. xx |

| | | | |
|---------------|-------------------------------|----------|------------|
| PROJECT | 1 West Landmark and Concourse | | |
| DRAWING TITLE | Case Perspective | | |
| | DESIGNED BY | DRAWN BY | CHECKED BY |
| | F. A. | F. A. | |

1W Concourse 100% v2015 .wvx

SHEET

SC1

1 West Landmark
and Concourse

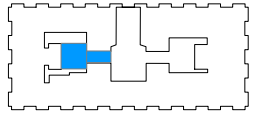

Key Floor Plan

1 West Concourse

Trademark Case
Hall of Fame Case
Interactive Panel

| DATE | SUBMITTAL |
|------------|----------------------------|
| 10/30/2014 | 100% Fabrication Submittal |

| REVISIONS | |
|------------|------------------------------|
| 09/30/2014 | 1. 65% Fabrication Submittal |
| xx/xx/xxxx | 2. xx |
| xx/xx/xxxx | 3. xx |
| xx/xx/xxxx | 4. xx |
| xx/xx/xxxx | 5. xx |
| xx/xx/xxxx | 6. xx |
| xx/xx/xxxx | 7. xx |

| | | | |
|---------------|-------------------------------|----------|------------|
| PROJECT | 1 West Landmark and Concourse | | |
| DRAWING TITLE | Case Artifacts | | |
| | DESIGNED BY | DRAWN BY | CHECKED BY |
| | F. A. | F. A. | |

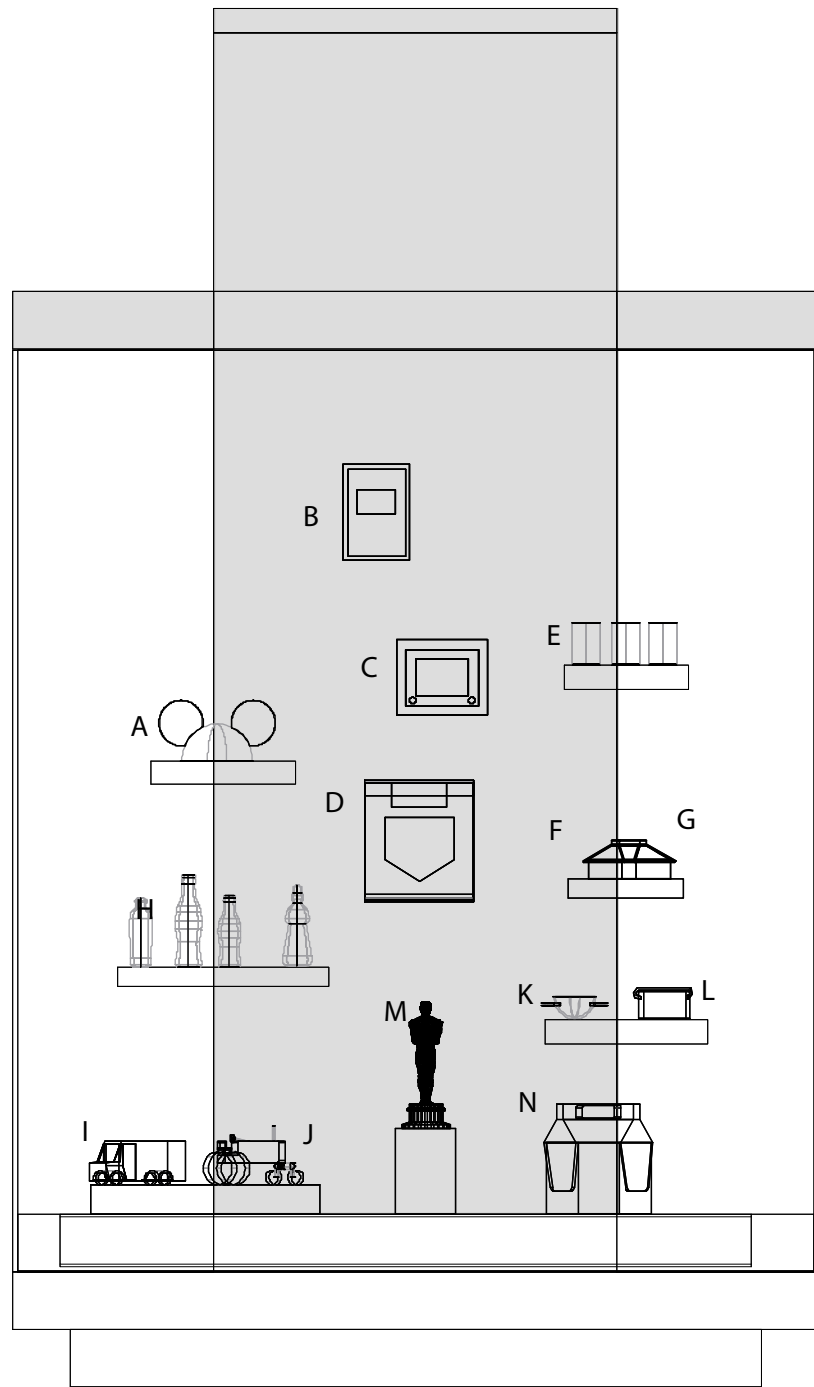

Trademark Case Artifacts:

- | | |
|------------------------|-----------------------------|
| A Mickey Mouse Ear Hat | H Coca-Cola Bottles |
| B National Geographic | I UPS Toy Truck |
| C Etch A Sketch | J John Deere Toy Tractor |
| D Levi's Jeans | K Red Cross Bowl |
| E Goya Food Products | L Barnum Animal Cracker Box |
| F Elmer's Glue | M Oscar |
| G Mrs. Butterworth | N Igloo Portable Cooler |

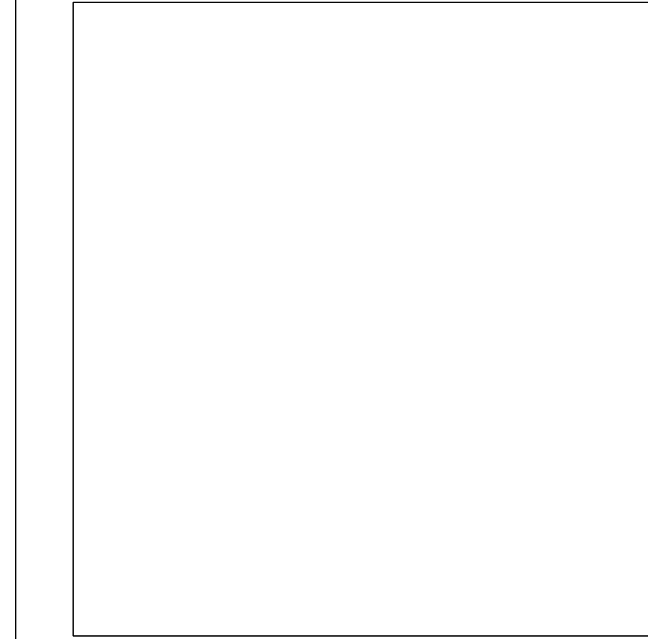

Hall of Fame Case Artifacts:

- | |
|---|
| A Apple 1 Microcomputer |
| B Sticky Note |
| C Kevlar |
| D Telephone Switch Circuit Board & Metal/Paper Card |
| E Ethernet Prototype Circuit Board |
| F Monolithic Phase Shift Oscillator |
| G Splice Box, Optic Fiber, & Notebook |

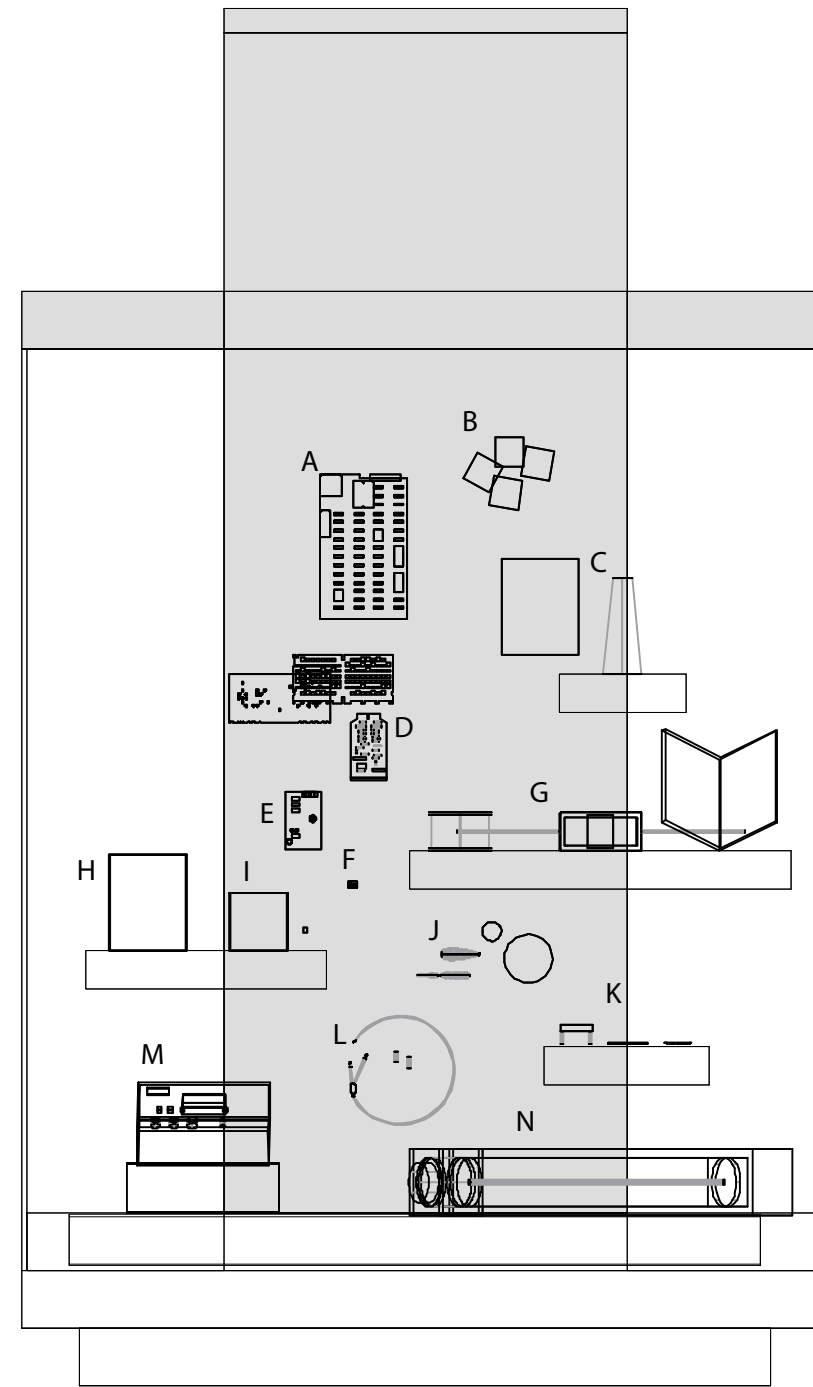

- | |
|---|
| H 1st Digital Camera |
| I CMOS Chip & Camera |
| J Semiconductor Boules & Wafers |
| K Solar Cells |
| L Palmaz Stents & Catheter |
| M Advent Noise Reduction System |
| N Helium-Neon Laser Discharge Apparatus |

| DATE | SUBMITTAL |
|------------|----------------------------|
| 10/30/2014 | 100% Fabrication Submittal |

| REVISIONS | |
|------------|------------------------------|
| 09/30/2014 | 1. 65% Fabrication Submittal |
| xx/xx/xxxx | 2. xx |
| xx/xx/xxxx | 3. xx |
| xx/xx/xxxx | 4. xx |
| xx/xx/xxxx | 5. xx |
| xx/xx/xxxx | 6. xx |
| xx/xx/xxxx | 7. xx |

| | | | |
|---------------|-------------------------------|----------|------------|
| PROJECT | 1 West Landmark and Concourse | | |
| DRAWING TITLE | Case plan & elevation | | |
| | DESIGNED BY | DRAWN BY | CHECKED BY |
| | F. A. | F. A. | |

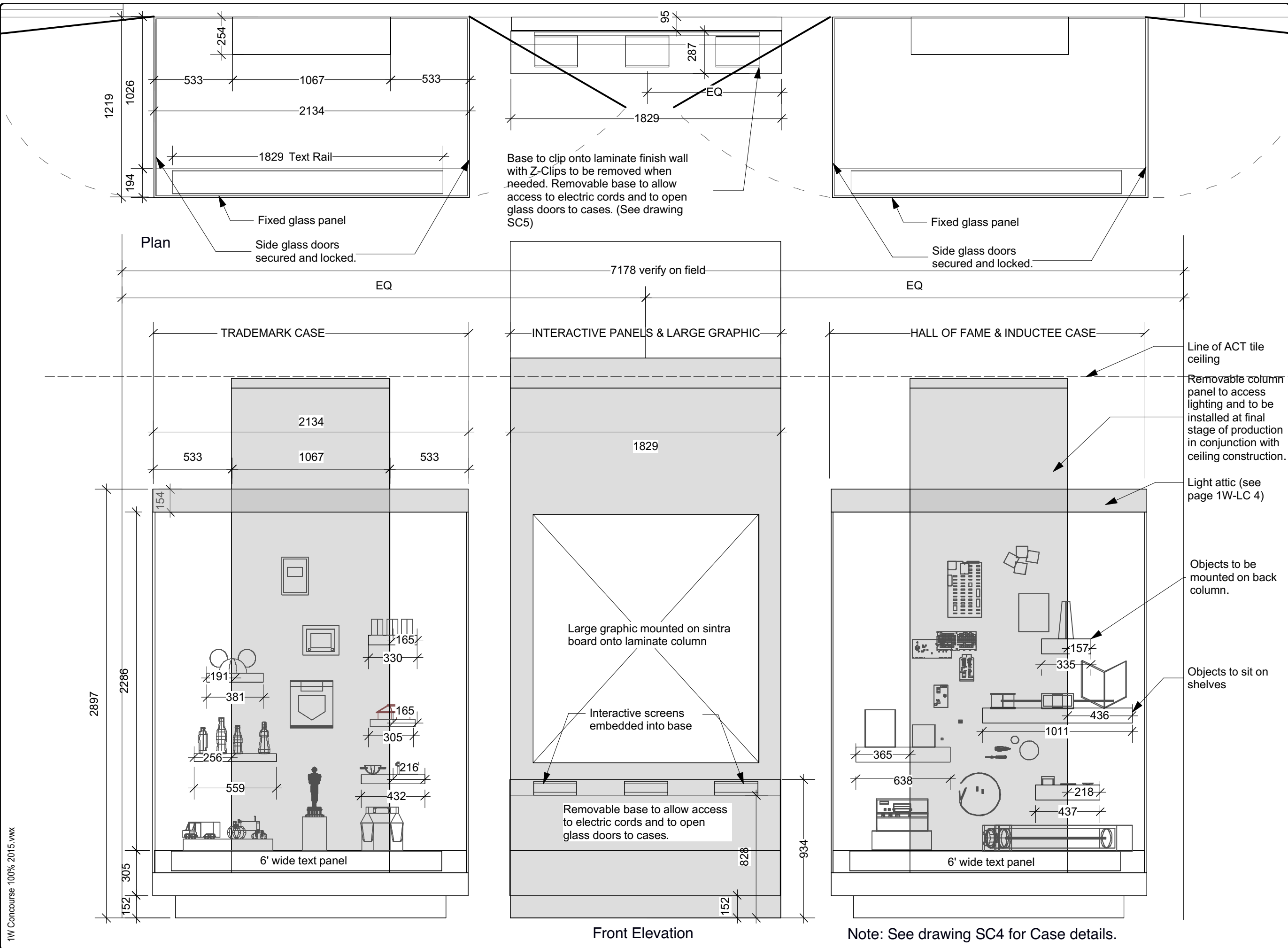

1W Concourse 100% 2015.vwx